



## Quick starting guide for mobile phones

To get Watchee started you basically have to follow three steps as described below.

### I. Register on [www.watchee.net](http://www.watchee.net)

to receive a loginname and a password. Remember it on a piece of paper.

Use this loginname and password for the Web-login and for your mobile phone/PDA/iPhone/Blackbox login.

### II. Download

Before download: Make sure that your mobile phone is able to connect to the Internet. Typically you can request on the homepage of your provider a free SMS , which configures your phone automatically for Internet access with GPRS.

- Mobile phone:  
type in following into the mobile phone browser <http://watchee.net/j>  
**alternative** type in a PC browser <http://watchee.net/download/Watchee.jar>  
(this results in downloading Watchee to your PC, where from you can send it to your mobile phone via Bluetooth)
- PDA (Windows Mobile):  
type in following into the PDA browser <http://watchee.net/c>  
**alternative** type in PC browser <http://watchee.net/download/Watchee.CAB>  
(this results in downloading Watchee to your PC, where from you can send it to your PDA via Bluetooth)

### Configure Watchee directly after the download

On very initial download of Watchee, after startup of the software, you will be situated in the configuration menu (the fourth screenshot at the right). Here you have to type in your **loginname and password**. After doing this, please go to step **III. Use case'**. If you have missed to type in the loginname and password correctly in the first place you have to start Watchee and do it manually:

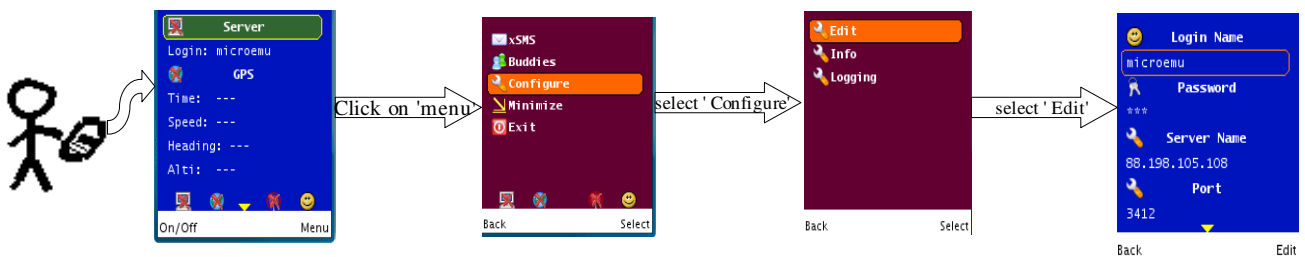

Click on Menu → select 'Configure' → select 'Edit' → enter 'Login Name' and 'Password'

Do that and enter your registered **loginname and password**. **Attention:** The entry is case sensitive. The same loginname can be used maximally for one or your mobile phone/PDA/iPhone/Blackbox.



## How to start Watchee

Where you can find the installed Watchee program on your phone depends on your phone model. Usually through *Menu* → *Programs* → *Watchee*.

### Further information:

You can change the authorizations of the Watchee program on your mobile phone. To lessen the recurring permission requests, which occurs for example if you want to take a photo or if you activate the Bluetooth-GPS mouse connection, check the phone specific application menu.





Some mobile phones need to interface the extern GPS mouse before the first start of Watchee (*System* → *Bluetooth*), a possibly requested password is typically *0000*.

## FAQ – What happens if the GPRS connection gets interrupted?

The data of your position is temporarily saved on your mobile phone and will be send to the Watchee server when the connection comes back, so that there is a constant tracking flow. This works right now for the mobile phones and some of the Blackbox variants but not yet for the PDA or iPhone version .

# III. Use case for mobile phones activate tracking



same principle with PDA/windows mobile/iPhone just with another user interface

<p>After starting Watchee on your phone, you will find yourself in the main overview screen:</p>	 <p style="text-align: center;">off</p>	 <p style="text-align: center;">on</p>
<p><b>activate through click on</b></p>	<p><b>off → connection establishment → on</b></p>	
<p><b>1. Server</b> data connection to the server (GPRS)</p>		
<p><b>2. GPS</b> connection to the local GPS</p>		
<p><b>3. Tracking</b> transmittance of the GPS data to the server*</p>		
<p>* data of your position is automatically send in variable time intervals, they differ from some seconds to several minutes depending on traveling speed and heading changes</p>		

## Videos for use case

<p>To visualize the use case the Watchee team created some short video clips          Video for mobile phone: <a href="http://watchee.net/css/images/j2me/enterLogin.gif">http://watchee.net/css/images/j2me/enterLogin.gif</a>          Video for windows-mobile: <a href="http://watchee.net/css/images/ce/Howtostart.gif">http://watchee.net/css/images/ce/Howtostart.gif</a>  <a href="http://watchee.net/css/images/ce/Howtoconnect.gif">http://watchee.net/css/images/ce/Howtoconnect.gif</a></p>
---

## What else can I do with Watchee on my mobile phone?

<p>1. Send real time photos to the Internet</p>	<p>Go back to main menu</p>	<p>2. Here you can send xSMS</p>
 <p>→ scroll to the very down on the main screen          → click for a snapshot and click on 'Ok' to post it automatically to the Internet</p>		 <p>→ send these to your friends or to the Internet</p>